

**X : 280008**  
**Y : 377855**



**Allwedd / Key**

Lleoliad arfaethedig Dim aros unrhyw adeg / Proposed location No waiting at any time █

Lleoliad Presennol Dim aros unrhyw adeg / Existing location No waiting at any time █

**NODDIAU / NOTES:**

\*Rhaid deparu pob mas ffordd geryddau yn unol â Rheoladau a Chyfarwyddadau Cyffwrddol Arwyddion Traffig 2002, y Llawlyfr Arwyddion Traffig (Pheroda 1-3), a darparu gan Lywodraeth Cymru - Rhaid deparu telun Cymraeg uwch ben y telun Saesneg, yn unol â pholisi Conwy.  
All cartographic information must be presented in accordance with the Traffic Signs and General Directions 2002, the Traffic Signs Manual (Chapters 1-3), and Welsh Assembly Government working drawings - Welsh text must be provided above English text, in per Conwy policy.  
\*Rheoladau dim aros unrhyw adeg yn unol â Rheoladau a Chyfarwyddadau Cyffwrddol Arwyddion Traffig 2002, y Llawlyfr Arwyddion Traffig (Pheroda 1-3), a darparu gan Lywodraeth Cymru - Rhaid deparu telun Cymraeg uwch ben y telun Saesneg, yn unol â pholisi Conwy.  
You are granted a non-exclusive, royalty free, revocable license solely to view the Licensed Data for non-commercial purposes for the period Conwy County Borough Council makes it available.  
You are not permitted to copy, sub-license, distribute, sell or make available the Licensed data to third parties in any form, and  
Third party rights to enforce the terms of this license shall be reserved to Ordnance Survey.

Ph/Rev	Manylion / Details	Dwyg Ph	Oesi gan	Dyddiad
DIWYGIADAU / REVISIONS (Os y'n berthnasol / When applicable)		Rev by	Chk by	Date



**Geraint Edwards, BEng (Hons) CEng FICE**

Pennaeth Gwasanaeth CYNGOR BWRDEISTREF SIROL CONWY / Head of Service CONWY COUNTY BOROUGH COUNCIL  
Yr Amgylchedd, Ffyrdd a Chylfeusterau / Environment, Roads and Facilities  
Caed Pella / Caeo Pella  
Baie Colwyn / Colwyn Bay  
LL29 7AZ

Graddfa / Scale: NTS

Darlunwyd gan / Drawn by: RJHR  
Awdurdodwyd gan / Authorized by: JCS

Adain / Section: Yr Amgylchedd, Ffyrdd a Chylfeusterau / Environment Roads and Facilities  
Dyddiad / Date: Mawrth 2025 / March 2025

Lleoliad / Location  
**Maes Derw Junction with Bryn Derw Llandudno Junction**

Teitl / Title:  
**Aros Arfaethedig Waiting Restrictions**

Llun Rhif / Dwg No:  
**TL11/14/24/02**

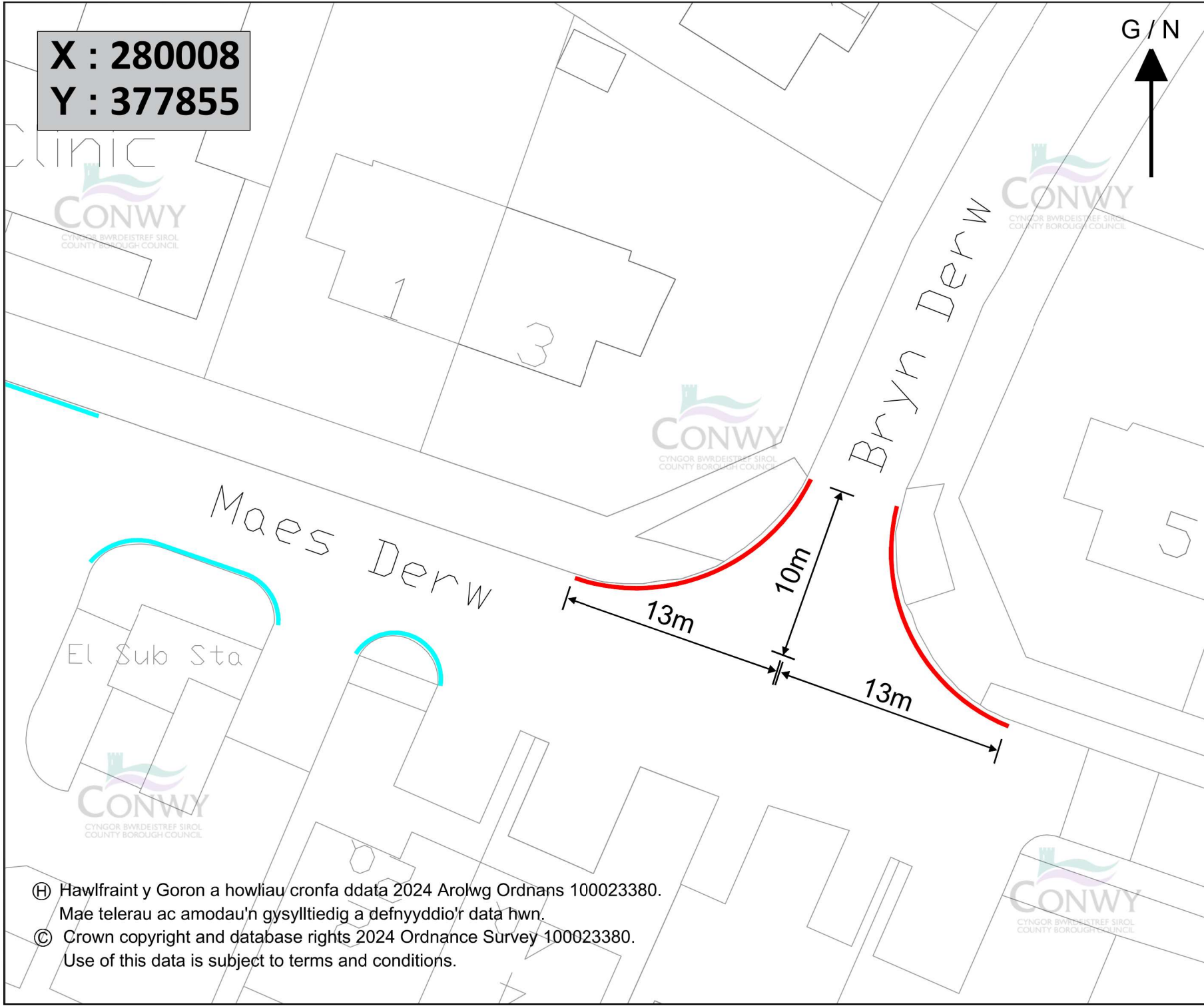

© Hawlfraint y Goron a howliau cronfa ddata 2024 Arolwg Ordnans 100023380.  
Mae telerau ac amodau'n gysylltiedig a defnyddio'r data hwn.  
© Crown copyright and database rights 2024 Ordnance Survey 100023380.  
Use of this data is subject to terms and conditions.