

### KEY

[This drawing must be reproduced in colour]

- T1/G1/W1 Trees
- Root Protection Area (RPA)
- Woody Vegetation (below BS5837 threshold for detailed survey)
- Approximate location (Feature not shown on supplied topographical survey)

**Tree Quality Categorisation**  
(Based on BS 5837:2012 Trees in relation to design, demolition and construction - Recommendations)

- Category A (High quality)
- Category B (Moderate quality)
- Category C (Low quality)
- Category U (Unsuitable for retention)

NOTE: This drawing should be read in conjunction with the respective Arboricultural Survey Data (Appendix A).



Reproduced by permission of Ordnance Survey on behalf of His Majesty's Stationery Office.  
© Crown Copyright and database right 2023. All rights reserved.

Rev	Description	Drawn	Approved	Date



401 Faraday Street, Birchwood Park, Warrington WA3 6GA  
Tel 01925 844004 e-mail tep@tep.uk.com www.tep.uk.com

Project  
RSPB Conwy Active Travel Link

Title  
Drawing 1: Tree Constraints Plan [BASELINE] - Overview

Drawing Number  
D10313.01.001

Drawn	Checked	Approved	Scale	Date
RMG	JGS	TDP	1:5,000 @ A3	07/08/2024

Table 1. Tree Constraints Baseline: Canopy Areas (ha), Feature Numbers and BS5837 Quality Categories

	Category A		Category B		Category C		Category U		Hedgerow (Not Categorised)	
	No. Features	Area (ha)	No. Features	Area (ha)	No. Features	Area (ha)	No. Features	Area (ha)	No. Features	Length (m)
<b>Trees</b>	0	0.0000	17	0.1377	20	0.0576	0	0.0000		
<b>Groups</b>	1	0.0839	9	2.8434	15	1.5212	0	0.0000		
<b>Woodlands</b>	0	0.0000	0	0.0000	0	0.0000	0	0.0000		
<b>Hedges</b>									0	0
<b>TOTAL</b>	1	0.0839	26	2.9811	35	1.5788	0	0.0000		



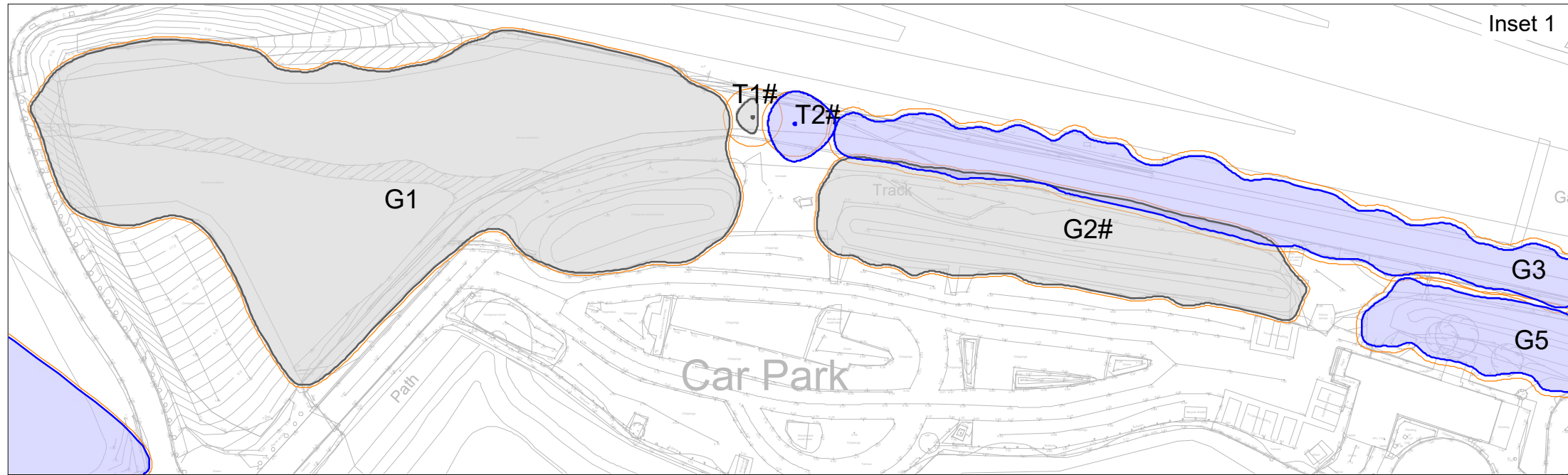

Inset 1

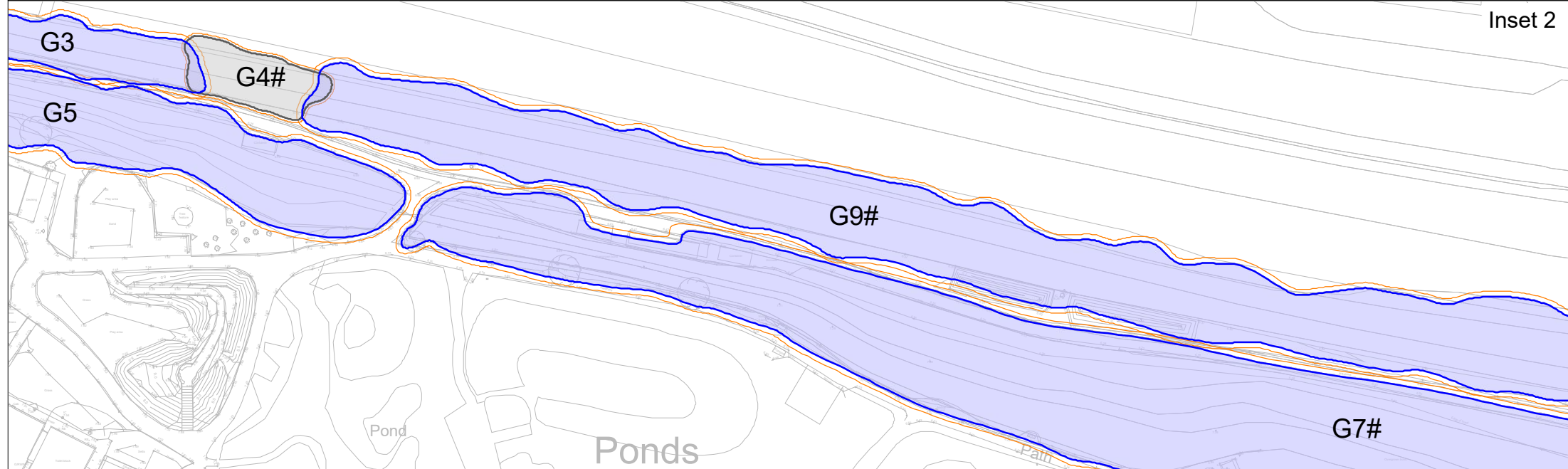

Inset 2

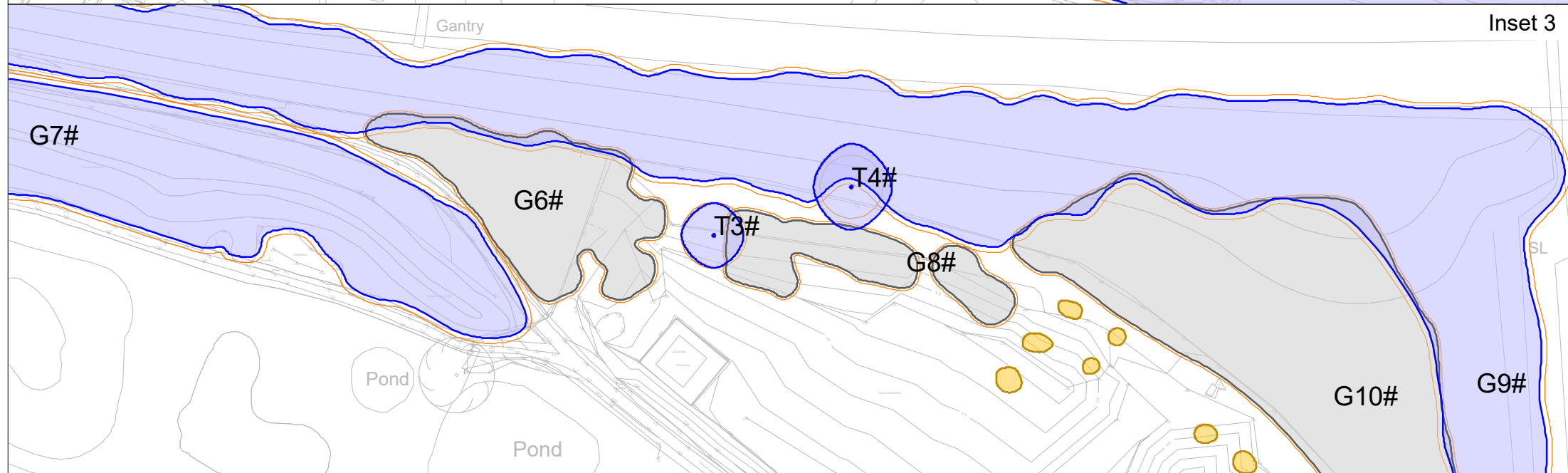

Inset 3

**KEY**

*[This drawing must be reproduced in colour]*

- T1/G1/W1 Trees
- Root Protection Area (RPA)
- Woody Vegetation (below BS5837 threshold for detailed survey)
- Approximate location (Feature not shown on supplied topographical survey)

**Tree Quality Categorisation**

*(Based on BS 5837:2012 Trees in relation to design, demolition and construction - Recommendations)*

- Category A (High quality)
- Category B (Moderate quality)
- Category C (Low quality)
- Category U (Unsuitable for retention)

NOTE: This drawing should be read in conjunction with the respective Arboricultural Survey Data (Appendix A).



Reproduced by permission of Ordnance Survey on behalf of His Majesty's Stationery Office.  
© Crown Copyright and database right 2023. All rights reserved.

Rev	Description	Drawn	Approved	Date



401 Faraday Street, Birchwood Park, Warrington WA3 6GA  
Tel 01925 844004 e-mail tep@tep.uk.com www.tep.uk.com

Project  
RSPB Conwy Active Travel Link

Title  
Drawing 1: Tree Constraints Plan [BASELINE] - Insets 1 to 3 of 9

Drawing Number  
D10313.01.002

Drawn	Checked	Approved	Scale	Date
RMG	JGS	TDP	1:1000 @ A3	07/08/2024

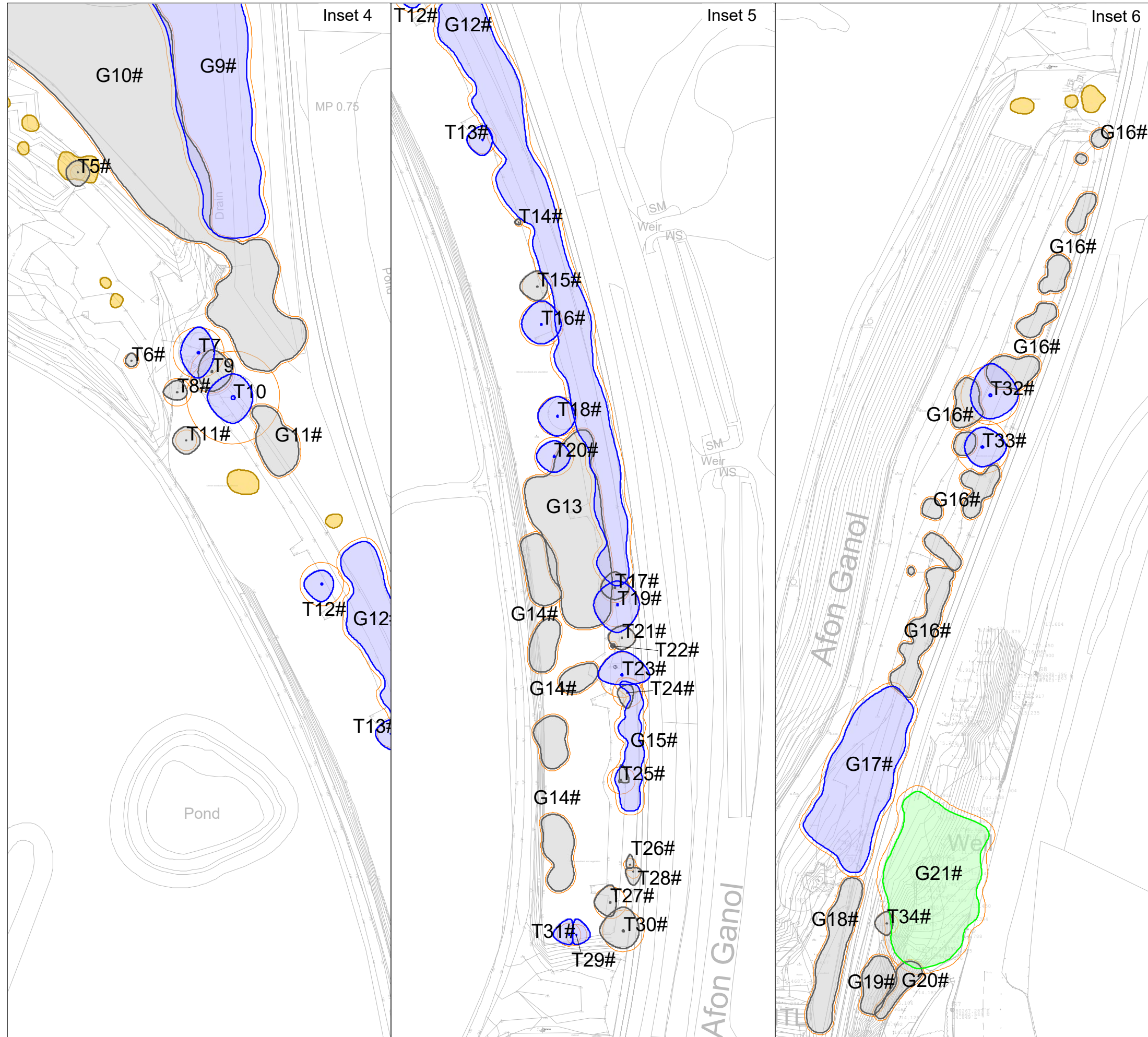

### KEY

[This drawing must be reproduced in colour]

- T1/G1/W1 Trees
- Root Protection Area (RPA)
- Woody Vegetation (below BS5837 threshold for detailed survey)
- # Approximate location (Feature not shown on supplied topographical survey)

### Tree Quality Categorisation

(Based on BS 5837:2012 Trees in relation to design, demolition and construction - Recommendations)

- Category A (High quality)
- Category B (Moderate quality)
- Category C (Low quality)
- Category U (Unsuitable for retention)

NOTE: This drawing should be read in conjunction with the respective Arboricultural Survey Data (Appendix A).



Reproduced by permission of Ordnance Survey on behalf of His Majesty's Stationary Office.  
© Crown Copyright and database right 2023. All rights reserved.

Rev	Description	Drawn	Approved	Date



401 Faraday Street, Birchwood Park, Warrington WA3 6GA  
Tel 01925 844004 e-mail tep@tep.uk.com www.tep.uk.com

Project  
RSPB Conwy Active Travel Link

Title  
Drawing 1: Tree Constraints Plan [BASELINE] - Insets 4 to 6 of 9

Drawing Number  
D10313.01.003

Drawn	Checked	Approved	Scale	Date
RMG	JGS	TDP	1:1000 @ A3	07/08/2024



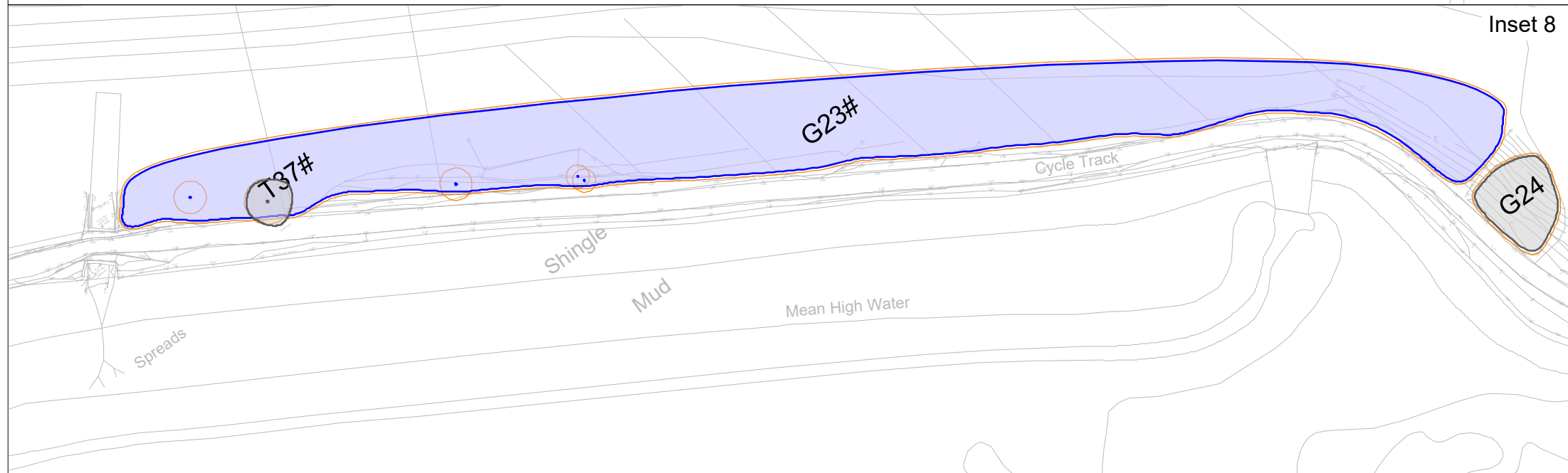
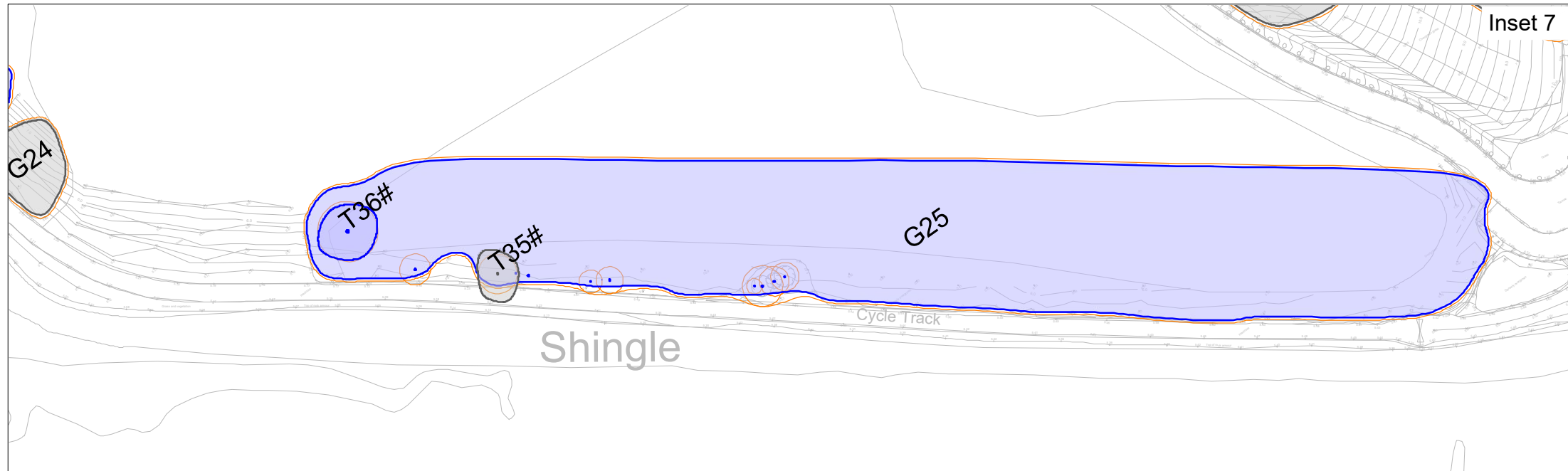

### KEY

[This drawing must be reproduced in colour]

- T1/G1/W1 Trees
- Root Protection Area (RPA)
- Woody Vegetation (below BS5837 threshold for detailed survey)
- # Approximate location (Feature not shown on supplied topographical survey)

**Tree Quality Categorisation**  
 (Based on BS 5837:2012 Trees in relation to design, demolition and construction - Recommendations)

- Category A (High quality)
- Category B (Moderate quality)
- Category C (Low quality)
- Category U (Unsuitable for retention)

NOTE: This drawing should be read in conjunction with the respective Arboricultural Survey Data (Appendix A).



Reproduced by permission of Ordnance Survey on behalf of His Majesty's Stationery Office.  
 © Crown Copyright and database right 2023. All rights reserved.

Rev	Description	Drawn	Approved	Date



401 Faraday Street, Birchwood Park, Warrington WA3 6GA  
 Tel 01925 844004 e-mail tep@tep.uk.com www.tep.uk.com

Project  
**RSPB Conwy Active Travel Link**

Title  
**Drawing 1: Tree Constraints Plan [BASELINE] - Insets 7 to 9 of 9**

Drawing Number  
**D10313.01.004**

Drawn	Checked	Approved	Scale	Date
RMG	JGS	TDP	1:1000 @ A3	07/08/2024

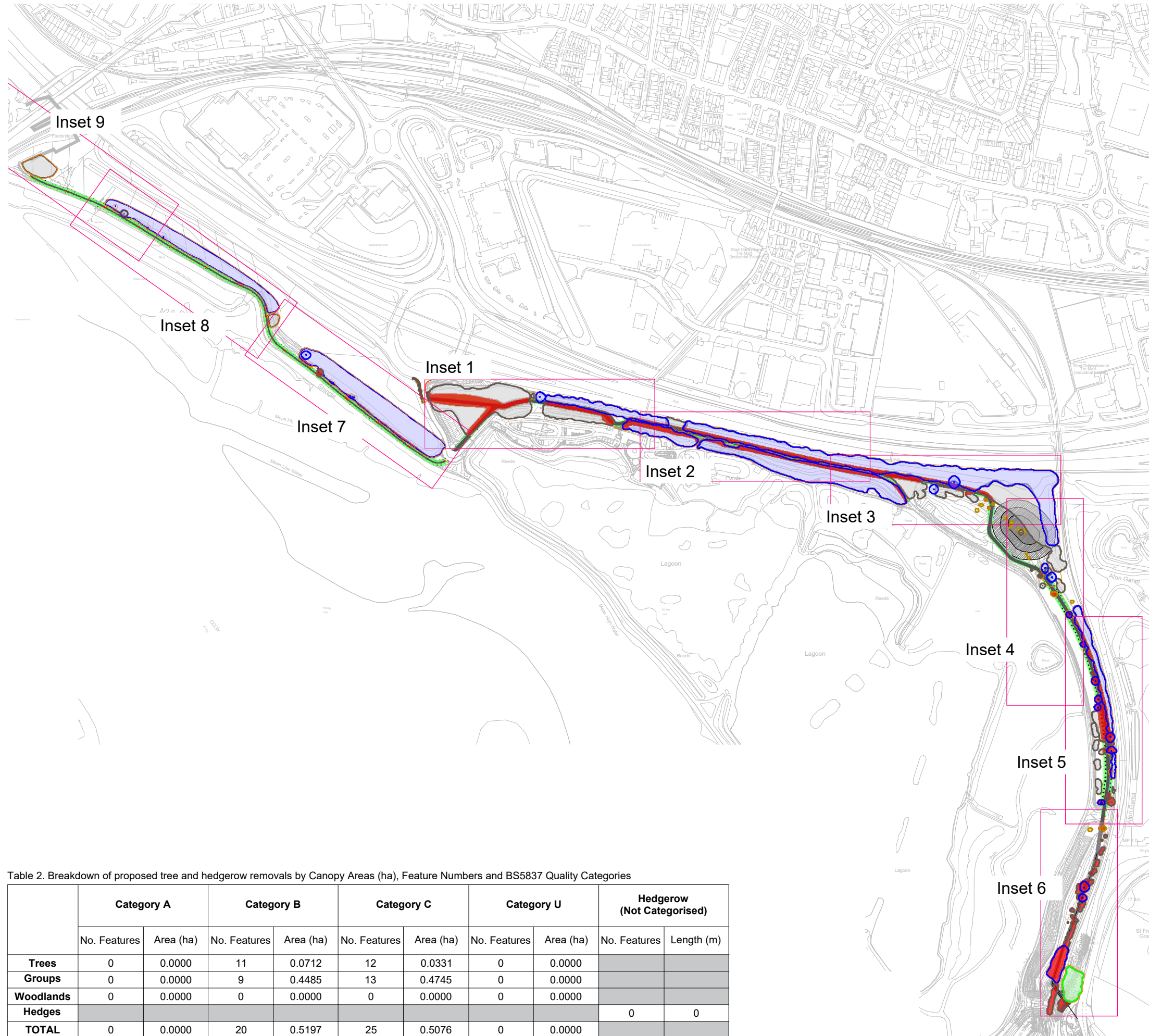

**KEY**

[This drawing must be reproduced in colour]

- T1/G1/W1 Trees
- Root Protection Area (RPA)
- Woody Vegetation (non-BS5837 applicable)
- # Approximate location (Feature not shown on supplied topographical survey)

**Trees and hedgerow to be retained and protected**

- Category A (High quality)
- Category B (Moderate quality)
- Category C (Low quality)
- Category U (May be retained for habitat value)

**Proposed tree and hedgerow works**

- Trees to be removed (Canopy outline denotes tree quality category)
- Trees to be pruned (Canopy outline denotes tree quality category)

NOTE: This drawing should be read in conjunction with the respective Arboricultural Survey Data (Appendix A).



Reproduced by permission of Ordnance Survey on behalf of His Majesty's Stationary Office.  
© Crown Copyright and database right 2023. All rights reserved.

Rev	Description	Drawn	Approved	Date



401 Faraday Street, Birchwood Park, Warrington WA3 6GA  
Tel 01925 844004 e-mail tep@tep.uk.com www.tep.uk.com

Project  
RSPB Conwy Active Travel Link

Title  
Drawing 2: Tree Works Plan [EFFECTS] - Overview

Drawing Number  
D10313.01.005

Drawn	Checked	Approved	Scale	Date
RMG	JGS	JGS	not to scale @ A3	07/08/2024

Table 2. Breakdown of proposed tree and hedgerow removals by Canopy Areas (ha), Feature Numbers and BS5837 Quality Categories

	Category A		Category B		Category C		Category U		Hedgerow (Not Categorised)	
	No. Features	Area (ha)	No. Features	Area (ha)	No. Features	Area (ha)	No. Features	Area (ha)	No. Features	Length (m)
<b>Trees</b>	0	0.0000	11	0.0712	12	0.0331	0	0.0000		
<b>Groups</b>	0	0.0000	9	0.4485	13	0.4745	0	0.0000		
<b>Woodlands</b>	0	0.0000	0	0.0000	0	0.0000	0	0.0000		
<b>Hedges</b>									0	0
<b>TOTAL</b>	0	0.0000	20	0.5197	25	0.5076	0	0.0000		



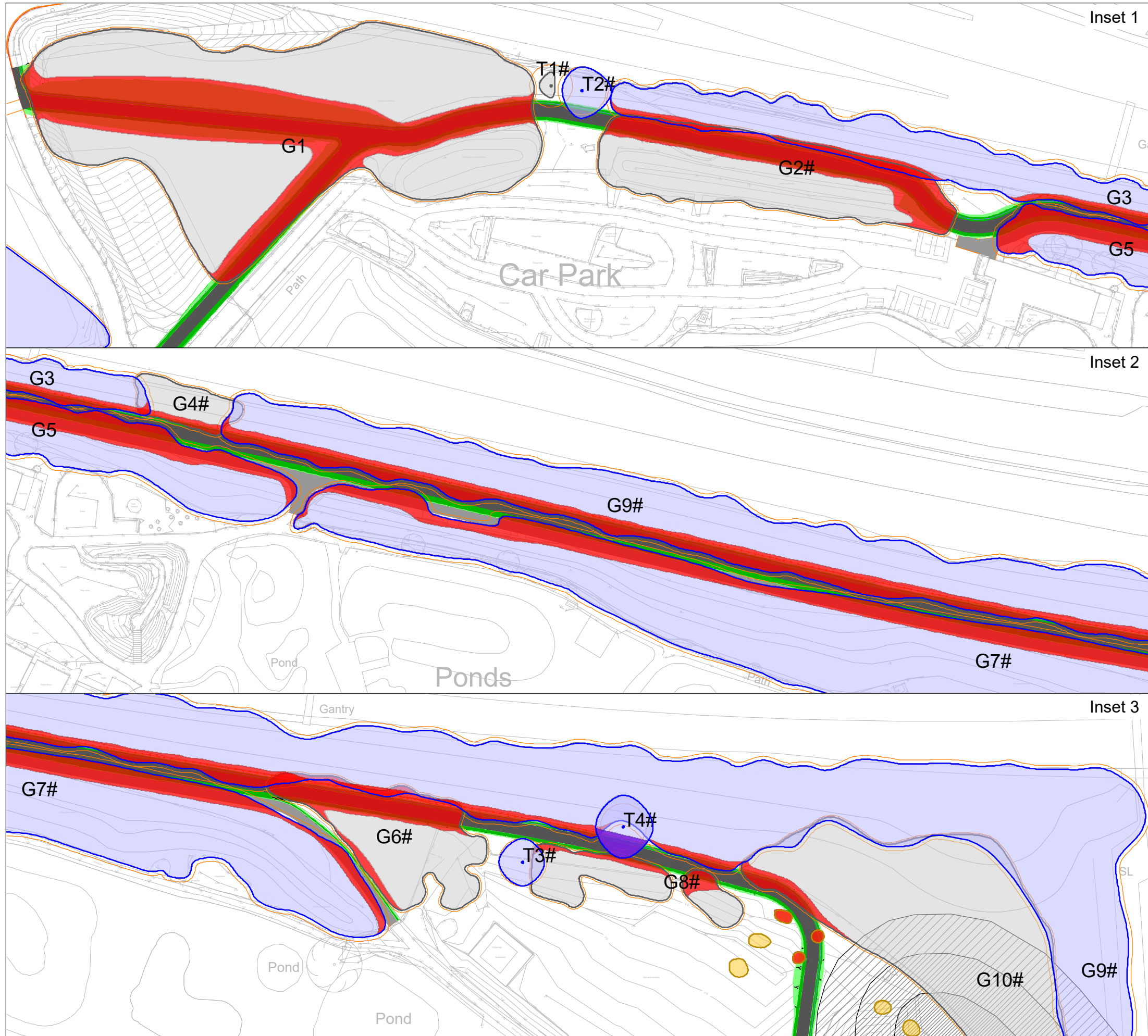

## KEY

[This drawing must be reproduced in colour]

- T1/G1/W1 Trees
- Root Protection Area (RPA)
- Woody Vegetation (non-BS5837 applicable)
- Approximate location (Feature not shown on supplied topographical survey)

### Trees and hedgerow to be retained and protected

- Category A (High quality)
- Category B (Moderate quality)
- Category C (Low quality)
- Category U (May be retained for habitat value)

### Proposed tree and hedgerow works

- Trees to be removed (Canopy outline denotes tree quality category)
- Trees to be pruned (Canopy outline denotes tree quality category)

NOTE: This drawing should be read in conjunction with the respective Arboricultural Survey Data (Appendix A).



Reproduced by permission of Ordnance Survey on behalf of His Majesty's Stationery Office.  
© Crown Copyright and database right 2023. All rights reserved.

Rev	Description	Drawn	Approved	Date



401 Faraday Street, Birchwood Park, Warrington WA3 6GA  
Tel 01925 844004 e-mail tep@tep.uk.com www.tep.uk.com

Project  
RSPB Conwy Active Travel Link

Title  
Drawing 2: Tree Works Plan [EFFECTS] - Insets 1 to 3 of 9

Drawing Number  
D10313.01.006

Drawn	Checked	Approved	Scale	Date
RMG	JGS	JGS	1:1000 @ A3	07/08/2024



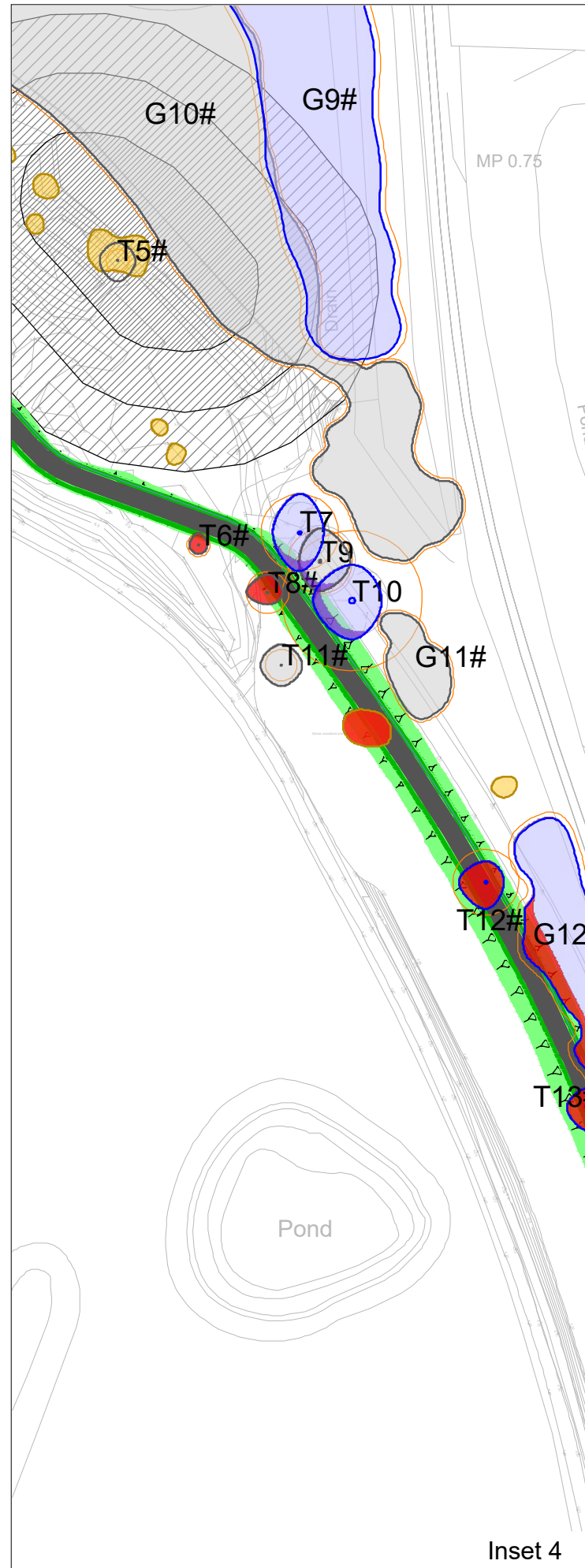

Inset 4

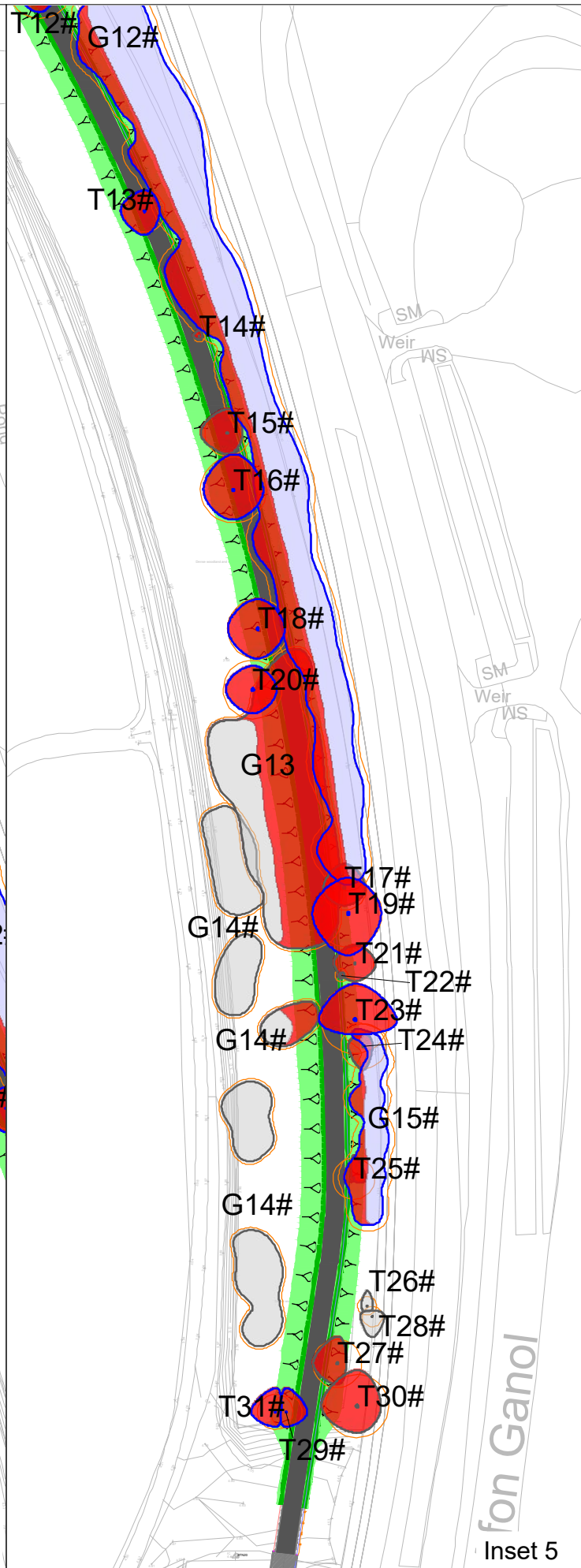

Inset 5

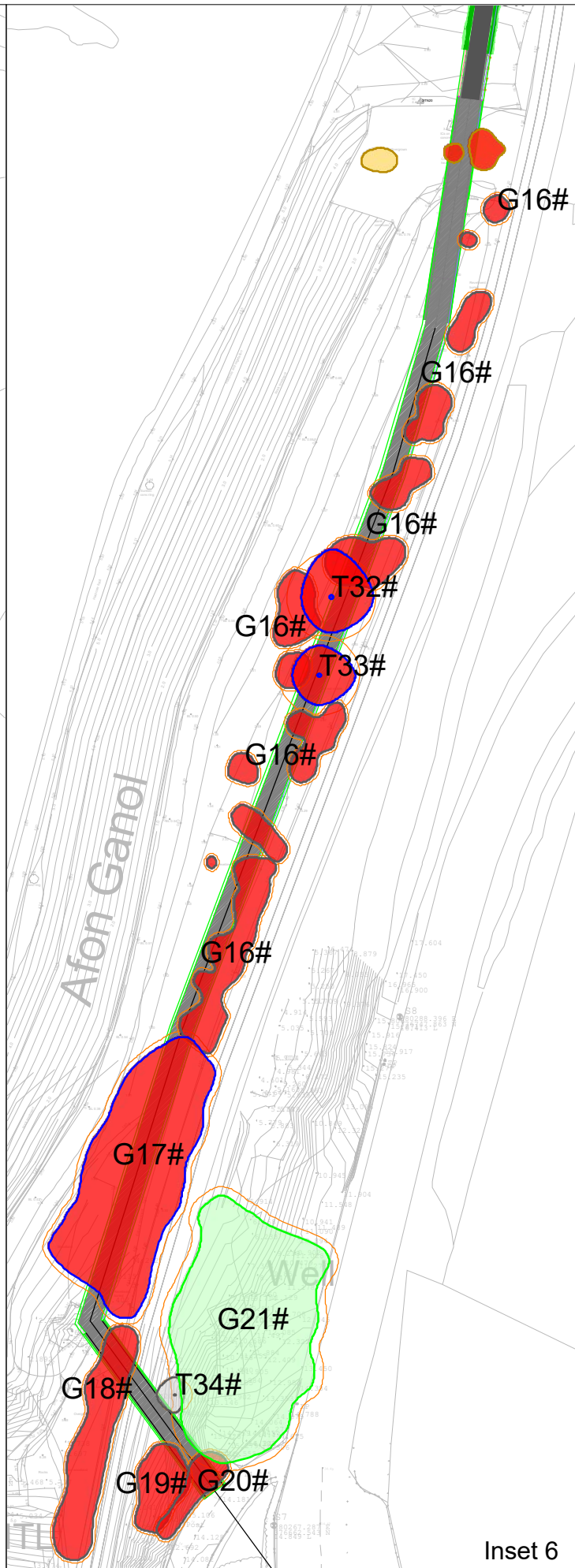

Inset 6

### KEY

[This drawing must be reproduced in colour]

- T1/G1/W1 Trees
- Root Protection Area (RPA)
- Woody Vegetation (non-BS5837 applicable)
- Approximate location (Feature not shown on supplied topographical survey)

#### Trees and hedgerow to be retained and protected

- Category A (High quality)
- Category B (Moderate quality)
- Category C (Low quality)
- Category U (May be retained for habitat value)

#### Proposed tree and hedgerow works

- Trees to be removed (Canopy outline denotes tree quality category)
- Trees to be pruned (Canopy outline denotes tree quality category)

NOTE: This drawing should be read in conjunction with the respective Arboricultural Survey Data (Appendix A).



Reproduced by permission of Ordnance Survey on behalf of His Majesty's Stationary Office.  
© Crown Copyright and database right 2023. All rights reserved.

Rev	Description	Drawn	Approved	Date



**THE ENVIRONMENT PARTNERSHIP**

401 Faraday Street, Birchwood Park, Warrington WA3 6GA  
Tel 01925 844004 e-mail tep@tep.uk.com www.tep.uk.com

Project  
RSPB Conwy Active Travel Link

Title  
Drawing 2: Tree Works Plan [EFFECTS] - Insets 4 to 6 of 9

Drawing Number  
D10313.01.007

Drawn	Checked	Approved	Scale	Date
RMG	JGS	JGS	1:1000 @ A3	07/08/2024

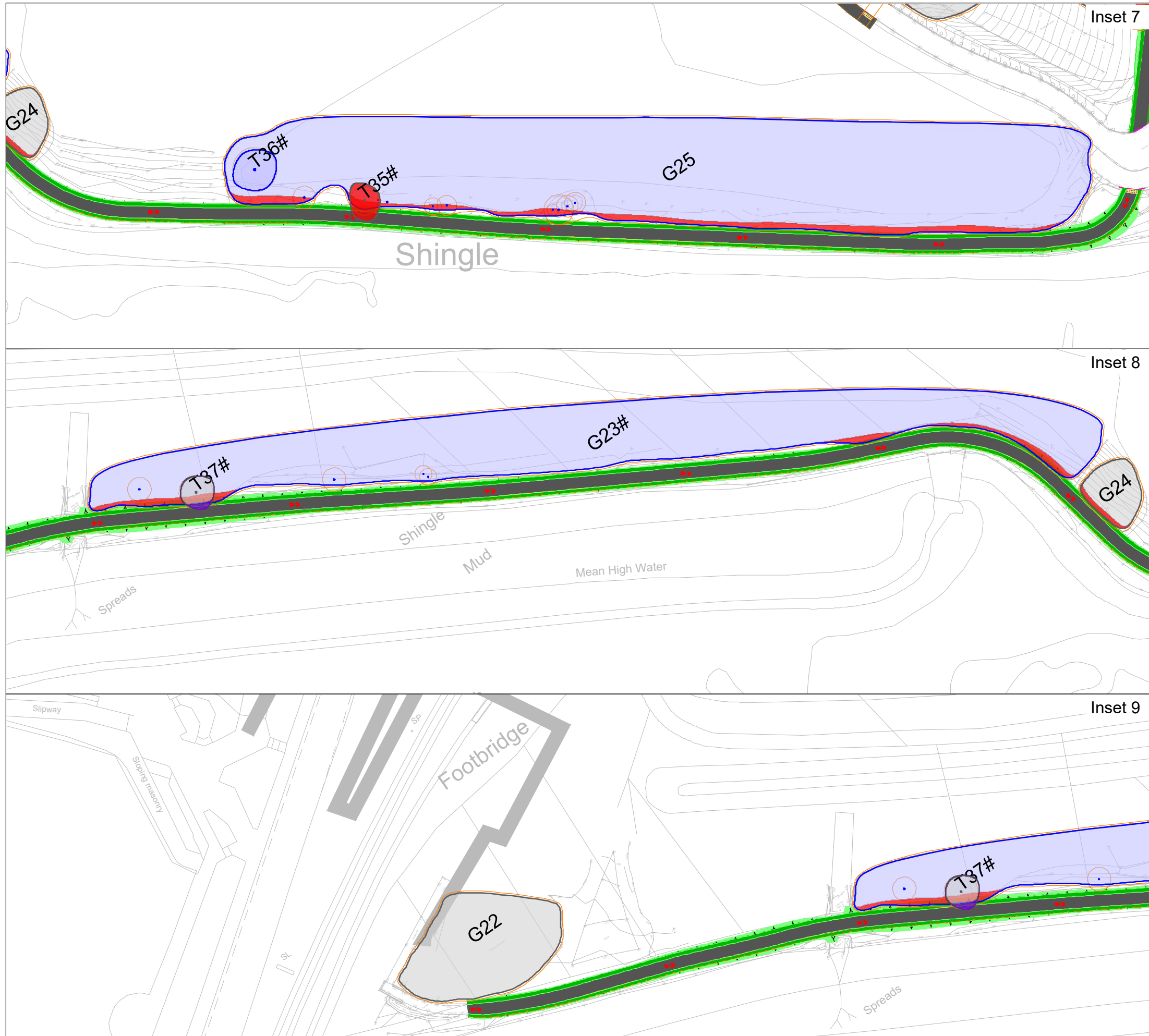

### KEY

[This drawing must be reproduced in colour]

- T1/G1/W1 Trees
- Root Protection Area (RPA)
- Woody Vegetation (non-BS5837 applicable)
- # Approximate location (Feature not shown on supplied topographical survey)

#### Trees and hedgerow to be retained and protected

- Category A (High quality)
- Category B (Moderate quality)
- Category C (Low quality)
- Category U (May be retained for habitat value)

#### Proposed tree and hedgerow works

- Trees to be removed (Canopy outline denotes tree quality category)
- Trees to be pruned (Canopy outline denotes tree quality category)

NOTE: This drawing should be read in conjunction with the respective Arboricultural Survey Data (Appendix A).



Reproduced by permission of Ordnance Survey on behalf of His Majesty's Stationery Office.  
© Crown Copyright and database right 2023. All rights reserved.

Rev	Description	Drawn	Approved	Date



401 Faraday Street, Birchwood Park, Warrington WA3 6GA  
Tel 01925 844004 e-mail tep@tep.uk.com www.tep.uk.com

Project  
RSPB Conwy Active Travel Link

Title  
Drawing 2: Tree Works Plan [EFFECTS] - Insets 7 to 9 of 9

Drawing Number  
D10313.01.008

Drawn	Checked	Approved	Scale	Date
RMG	JGS	TDP	1:1000 @ A3	07/08/2024



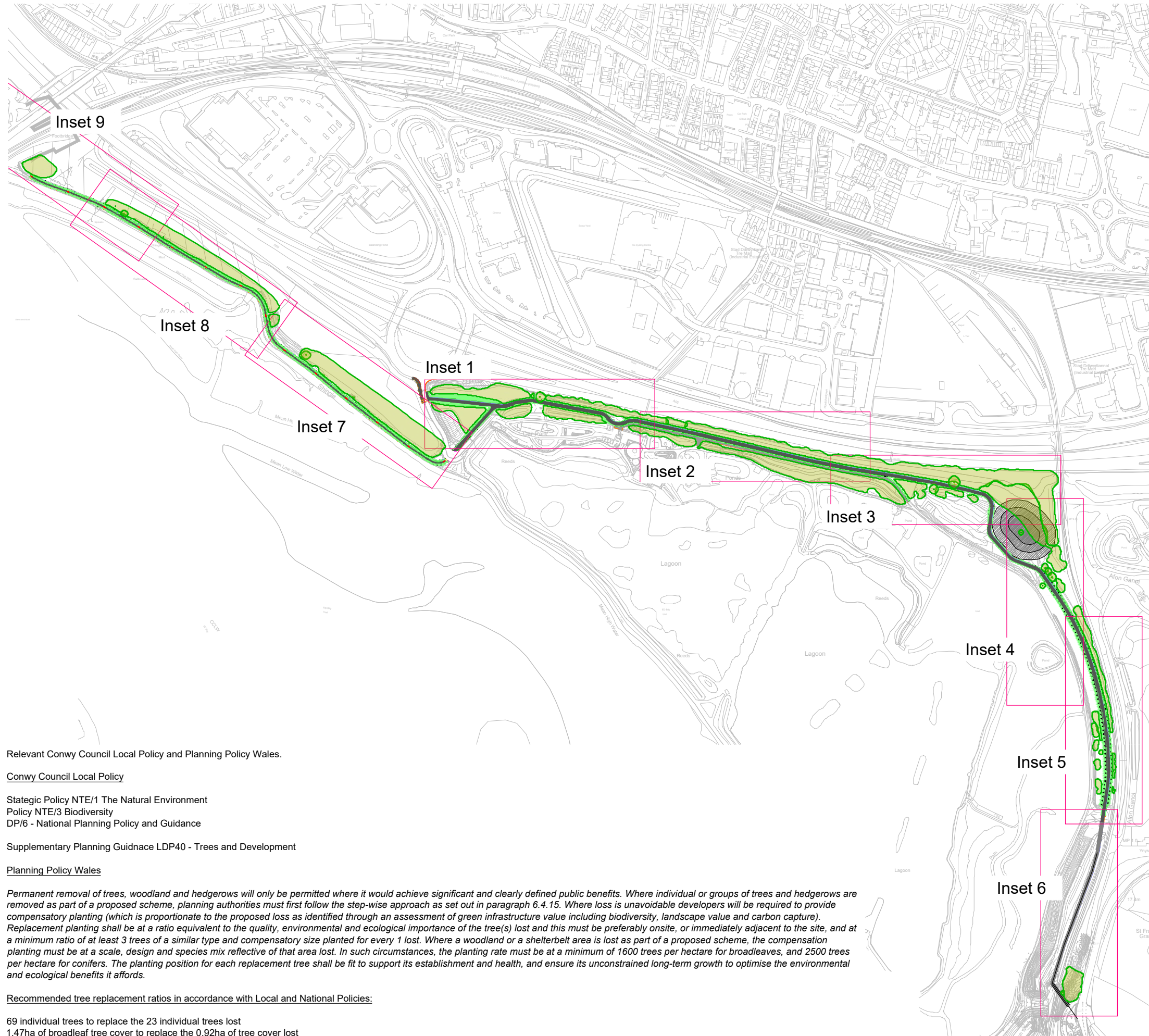

**KEY**

[This drawing must be reproduced in colour]

- ■ T1/G1/W1 Retained trees, groups and woodland
- Root Protection Area (RPA)

Relevant Conwy Council Local Policy and Planning Policy Wales.

Conwy Council Local Policy

Strategic Policy NTE/1 The Natural Environment  
 Policy NTE/3 Biodiversity  
 DP/6 - National Planning Policy and Guidance

Supplementary Planning Guidance LDP40 - Trees and Development

Planning Policy Wales

*Permanent removal of trees, woodland and hedgerows will only be permitted where it would achieve significant and clearly defined public benefits. Where individual or groups of trees and hedgerows are removed as part of a proposed scheme, planning authorities must first follow the step-wise approach as set out in paragraph 6.4.15. Where loss is unavoidable developers will be required to provide compensatory planting (which is proportionate to the proposed loss as identified through an assessment of green infrastructure value including biodiversity, landscape value and carbon capture). Replacement planting shall be at a ratio equivalent to the quality, environmental and ecological importance of the tree(s) lost and this must be preferably onsite, or immediately adjacent to the site, and at a minimum ratio of at least 3 trees of a similar type and compensatory size planted for every 1 lost. Where a woodland or a shelterbelt area is lost as part of a proposed scheme, the compensation planting must be at a scale, design and species mix reflective of that area lost. In such circumstances, the planting rate must be at a minimum of 1600 trees per hectare for broadleaves, and 2500 trees per hectare for conifers. The planting position for each replacement tree shall be fit to support its establishment and health, and ensure its unconstrained long-term growth to optimise the environmental and ecological benefits it affords.*

Recommended tree replacement ratios in accordance with Local and National Policies:

69 individual trees to replace the 23 individual trees lost  
 1.47ha of broadleaf tree cover to replace the 0.92ha of tree cover lost



Reproduced by permission of Ordnance Survey on behalf of His Majesty's Stationery Office.  
 © Crown Copyright and database right 2023. All rights reserved.

Rev	Description	Drawn	Approved	Date



401 Faraday Street, Birchwood Park, Warrington WA3 6GA  
 Tel 01925 844004 e-mail tep@tep.uk.com www.tep.uk.com

Project  
**RSPB Conwy Active Travel Link**

Title  
**Drawing 3: Tree Protection Plan [MITIGATION] - Overview**

Drawing Number  
**D10313.01.009**



Drawn	Checked	Approved	Scale	Date
RMG	JGS	JGS	not to scale @ A3	07/08/2024

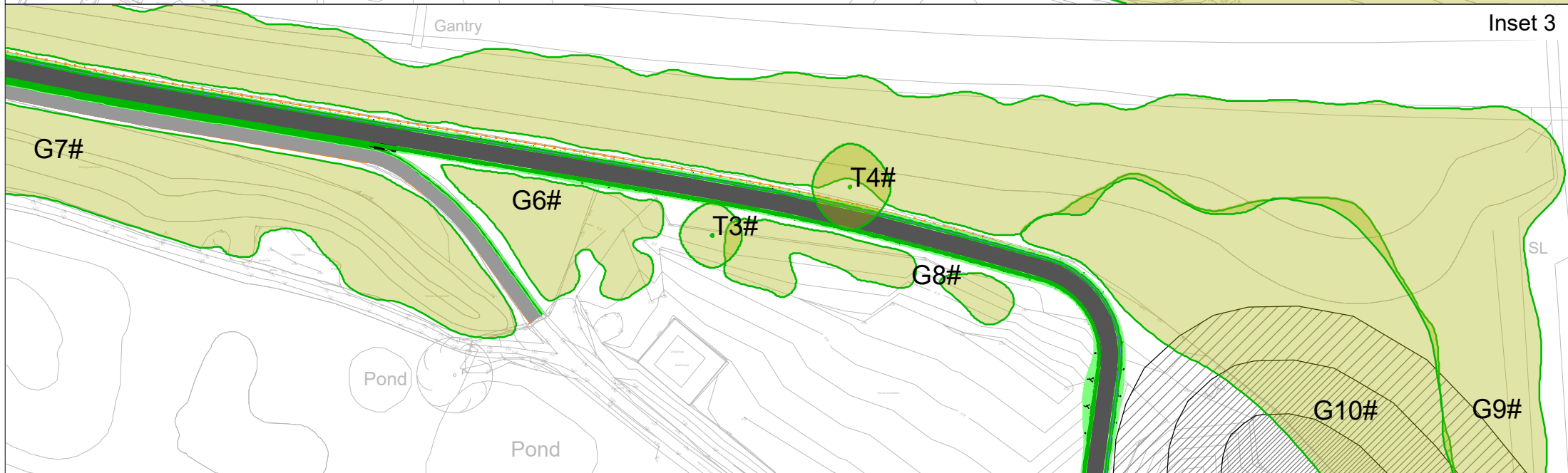
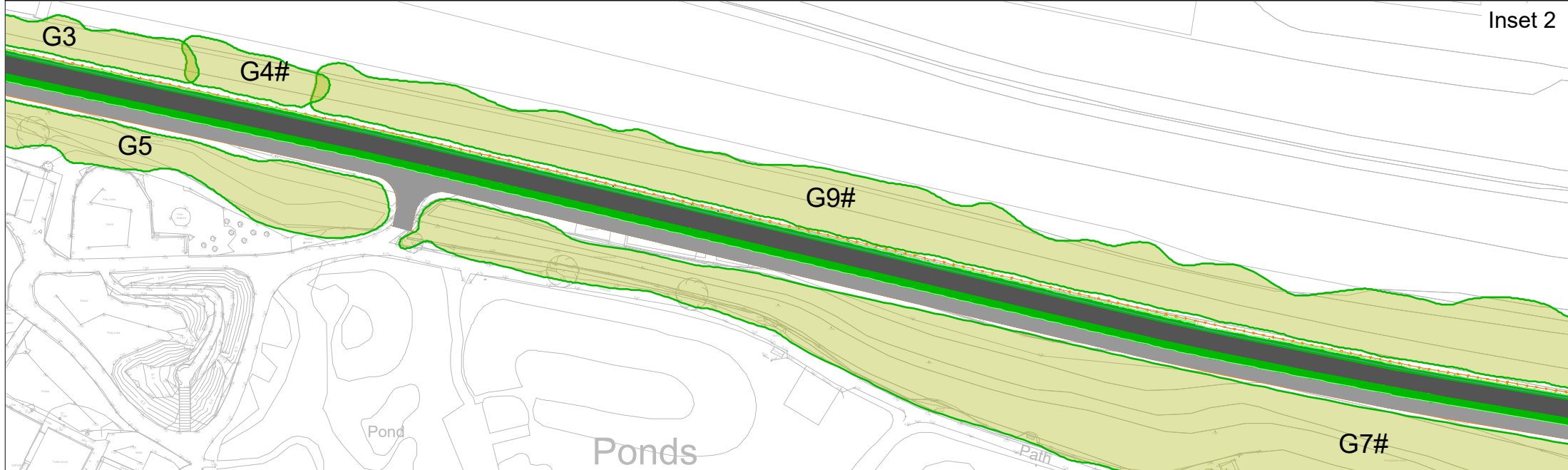
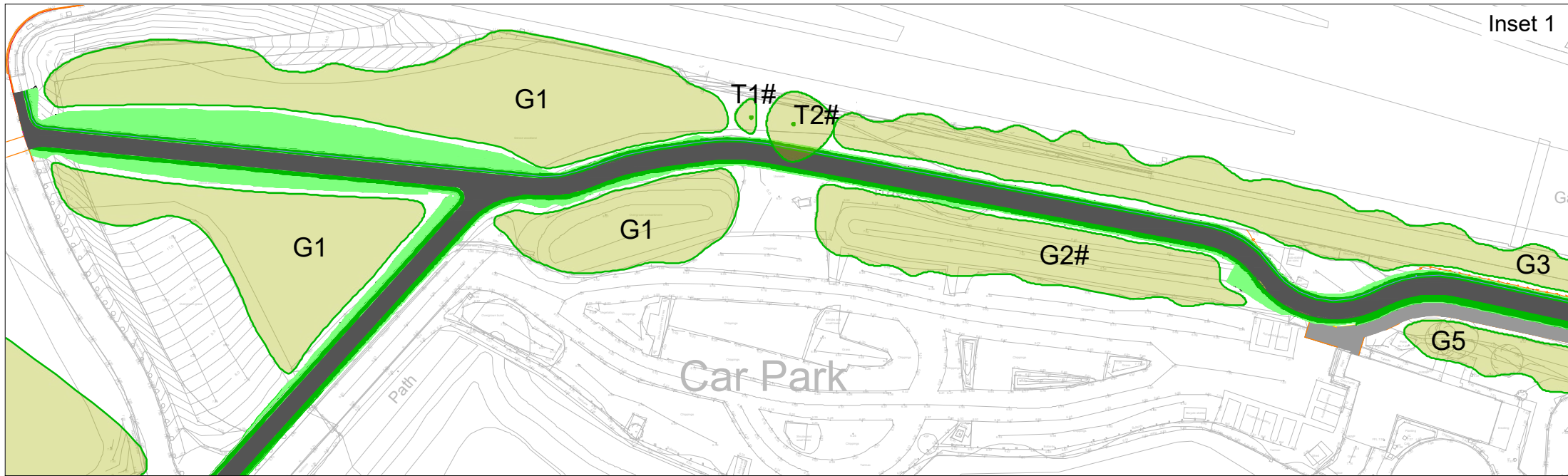



**KEY**

[This drawing must be reproduced in colour]

-   T1/G1/W1 Retained trees, groups and woodland
-  Root Protection Area (RPA)



Reproduced by permission of Ordnance Survey on behalf of His Majesty's Stationary Office.  
© Crown Copyright and database right 2023. All rights reserved.

Rev	Description	Drawn	Approved	Date



401 Faraday Street, Birchwood Park, Warrington WA3 6GA  
Tel 01925 844004 e-mail tep@tep.uk.com www.tep.uk.com

Project  
RSPB Conwy Active Travel Link

Title  
Drawing 3: Tree Protection Plan [MITIGATION] - Insets 1 to 3 of 9

Drawing Number  
D10313.01.010

Drawn	Checked	Approved	Scale	Date
RMG	JGS	JGS	1:1000 @ A3	07/08/2024





Inset 4



Inset 5



Inset 6

**KEY**  
 [This drawing must be reproduced in colour]

- T1/G1/W1 Retained trees, groups and woodland
- Root Protection Area (RPA)

Reproduced by permission of Ordnance Survey on behalf of His Majesty's Stationary Office.  
 © Crown Copyright and database right 2023. All rights reserved.

Rev	Description	Drawn	Approved	Date

**THE ENVIRONMENT PARTNERSHIP**  
 401 Faraday Street, Birchwood Park, Warrington WA3 6GA  
 Tel 01925 844004 e-mail tep@tep.uk.com www.tep.uk.com

Project  
**RSPB Conwy Active Travel Link**

Title  
**Drawing 3: Tree Protection Plan [MITIGATION] - Insets 4 to 6 of 9**

Drawing Number  
**D10313.01.011**

Drawn	Checked	Approved	Scale	Date
RMG	JGS	JGS	1:1000 @ A3	07/08/2024



### KEY

[This drawing must be reproduced in colour]

- T1/G1/W1 Retained trees, groups and woodland
- Root Protection Area (RPA)



Reproduced by permission of Ordnance Survey on behalf of His Majesty's Stationary Office.  
© Crown Copyright and database right 2023. All rights reserved.

Rev	Description	Drawn	Approved	Date



401 Faraday Street, Birchwood Park, Warrington WA3 6GA  
Tel 01925 844004 e-mail tep@tep.uk.com www.tep.uk.com

Project  
RSPB Conwy Active Travel Link

Title  
Drawing 3: Tree Protection Plan [MITIGATION] - Insets 7 to 9 of 9

Drawing Number  
D10313.01.012

Drawn	Checked	Approved	Scale	Date
RMG	JGS	TDP	1:1000 @ A3	07/08/2024